



## *The Veu Home Elevator*



*Safety In Motion*



## *The Veu Home Elevator*

*The Veu represents the latest in Home Elevator technology offering elegance, beauty and easy access to each level of your home from the basement to the attic with the push of a button.*

*The Veu is equipped with safety features that match or surpass commercial elevator systems, providing maximum protection.*

*With the Veu there is no such thing as upgrading when it comes to safety, all our features are offered as part of the standard package.*

***The Veu  
Simply the best Elevator in its' class.***





# Inside The Veu Elevator Cabs...

## Ceiling Panels & Wall Panels

Ceiling Panels



Raised Panels



Veneer Panels



## Plastic Laminate Options

Wall Panels



Ceiling Panels



## Ceiling Panel, Raised Panel and Veneer Panel Options

### On Birch

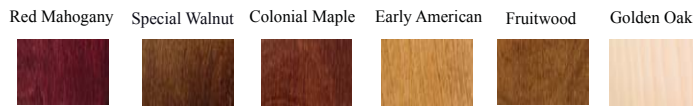

### On Cherry



### On Oak



## Plastic Laminate Color Samples



For specific color samples visit [www.formica.com](http://www.formica.com)



## Hand Rails

*Solid Oak*



*Aluminium*



### WoodFinishes

*Clear or Gold Anodized*

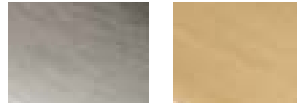
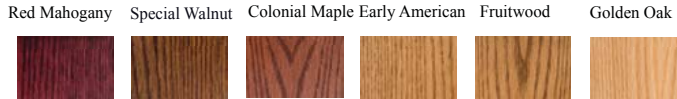

## C.O.P

## Call Stations

*Stainless Steel*

*Brass*



*Stainless Steel*

*Brass*



## Lighting



### Trim Options

*Black*



*Stainless Steel Brushed*



*Chrome*



*White*



*Brushed Brass*



*Brass*





## Automatic Doors

*Vertechs believes “Safety should not be a luxury”.*

*The Vertechs Veu is engineered with automatic doors that open and close with the push of a button like a real elevator. Vertechs considers the use of swing doors and folding gates a poor approach to cut down on prices.*



*Beige Doors*

## Full Range Light Curtain

*The Veu’s automatic doors are equipped with full range light curtains. This feature prevents the door from closing if an obstruction is detected, providing maximum protection to children, adults and pets.*



*Stainless Steel Doors*



## Veü Product Specifications

### General Specifications

- **Drive:** 2:1 hydraulic system
- **Capacity:** 950lbs (430kg)
- **Total Gross Load:** 1900 lb. (863 kg)
- **Speeds:** 40 fpm
- **Pit:** 10in. Min. (254mm.)
- **Overhead:** 108in. Min. (2744mm)
- **Travel:** 504in. Max. (42ft) (12800mm)
- **Stops:** 5 Max.

### Cab Clear Inside

- 36in X 48in X 84in. (12sq ft)
- 36in X 60in X 84in. (15sq ft)

### Standard Equipment

- **Cab Entrance:** steel black enamel
- **Cab Doors:** two speed fully automatic sliding doors powder coated beige
- **Landing entrance and Doors:** powder coated beige
- **Door Sills:** clear aluminium
- **Handrail:** clear aluminium brushed finish
- **Cab Panels:** plastic laminate with formica finishes or wood veneer stained/lacquer or unfinished
- **Cab Ceiling:** plastic laminate with formica finishes or wood veneer stained/lacquer or unfinished
- **Lighting:** automatic on/off 2 pot-lights
- **Operation:** selective collective
- **Call Stations:** brushed stainless steel with illuminated push buttons
- **Car Operating Panel (C.O.P):** brushed stainless steel with illuminated push buttons, stop switch, emergency light, programmable speakerphone

### Standard Safety Features

- **Power Backup:** battery backup during power failure
- **Emergency lowering:** manual lowering button
- **Emergency stop:** emergency stop switch inside car
- **Automatic Door Interlocks:** CSA/UL approved interlocks preventing landing door opening when car not at the floor
- **Door restrictor:** mechanical-magnetic restrictor preventing cab door opening when car not at the landing
- **Line Rupture Valve (LRV):** line rupture safety valve
- **Auto Re-levelling:** anti-creep releveling system
- **Door-bypass detection:** detects bypass of door contacts
- **Slack Rope Safety:** slack rope safety break
- **Micro-Scan Motion Detectors:** motion detection light curtains preventing doors from closing

### Mechanical / Hydraulic

- **Guide Rails:** 8lb T-rail pre-welded for smooth ride
- **Car Frame:** T-601 cantilever system
- **Power Unit:** GMV ultima
- **Motor/Pump:** submersible for quiet operation
- **Control Valve:** 2 speed with soft stop
- **Jack:** single stage with LRV system

### Controls

- **Elevator Controller:** CSA/TSSA approved micro-controller based system with solid-state devices- no mechanical relays
- **Wiring:** plug and play harness with electrical duct

### Power Requirements

- **Main and lighting:** single phase, 220V and 110V

### Options

- **Cab Doors:** stainless steel brushed finish
- **Landing entrance & Doors:** stainless steel brushed finish
- **Door Sills:** aluminium brass anodized
- **Handrail:** solid brass brushed finish or solid oak stained/lacquer or unfinished,
- **Cab Wall Panels:** raised solid wood stained/lacquer or unfinished
- **Light Trims:** 6 different colors to choose from
- **Call Stations:** brass brushed finish
- **Car Operating Panel (C.O.P):** brass brushed finish

### Additional Information

- limited two year warranty
- job specific layout drawings
- detailed architectural hoistway construction drawings
- optional maintenance service
- complete pre-tested system
- installation and service provided by professional local dealer





# Vertechs *VEU* Hoistway Drawings

VEU HOME ELEVATOR: *In Line*

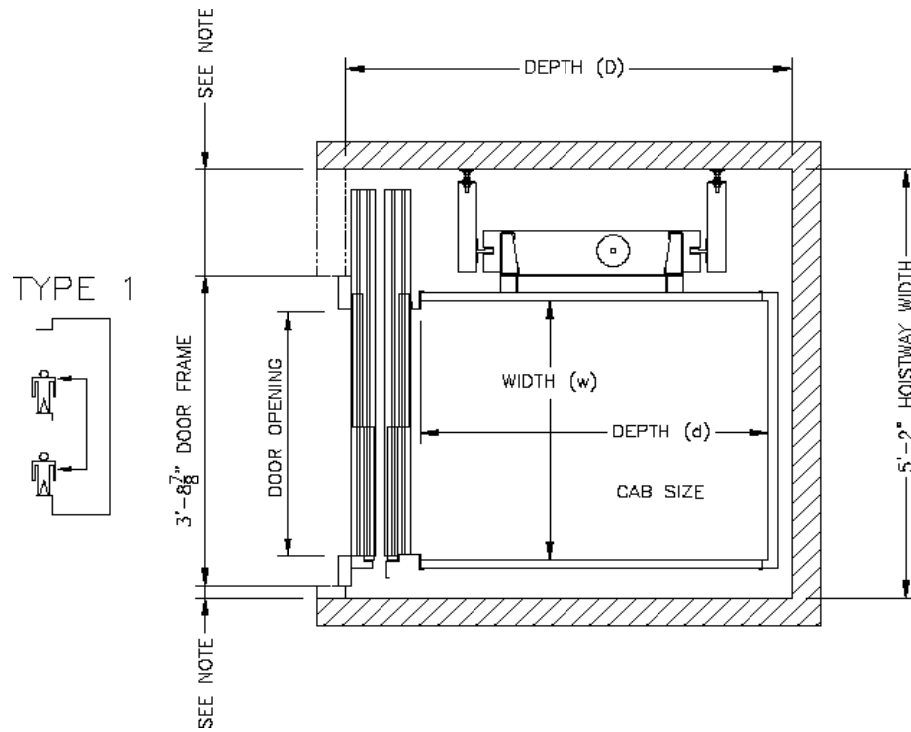

VEU HOME ELEVATOR: *Front and Rear Entrance*

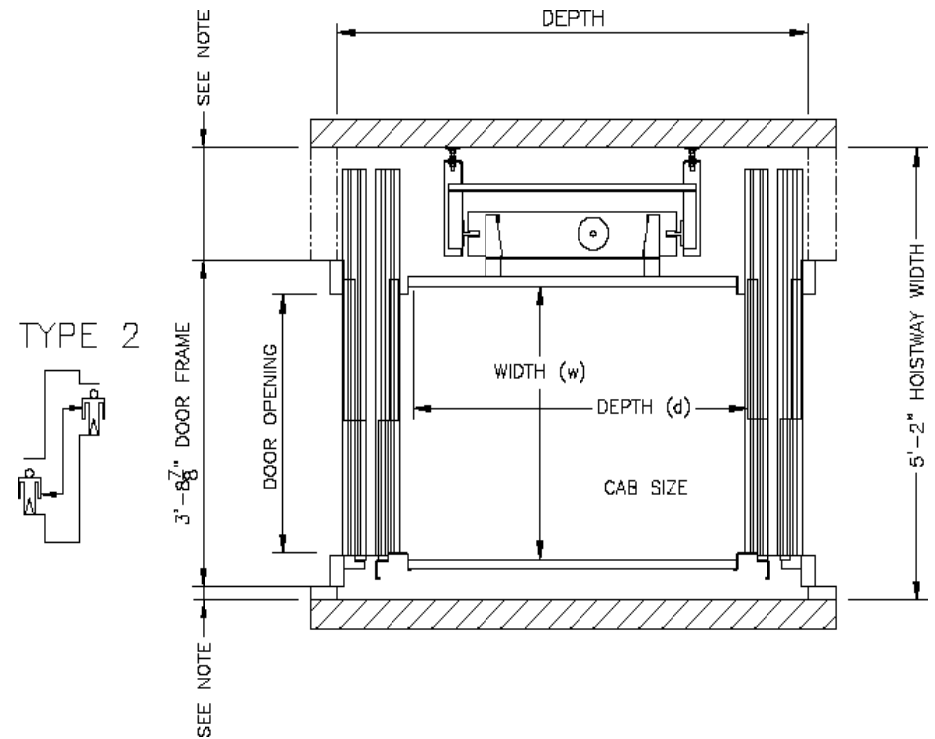

Hoistway Size W x D	Cab Size w x d x h (in)	Door Opening W x H (in)
62 x 63	36 x 48 x 84	36 x 80
62 x 75	36 x 60 x 84	36 x 80

Hoistway Size W x D (in)	Cab Size w x d x h (in)	Door Opening w x h (in)
62 x 69	36 x 48 x 84	36 x 80
62 x 81	36 x 60 x 84	36 x 80



## *Contact Information*

*Phone Number: 519-621-8443*

*Fax Number: 519-621-3211*

*Toll Free Number: 1-888-320-5438*

*Email Address: sales@vertechselevators.com*

*Website: www.vertechselevators.com*

*Address: 31-130 Cedar St. Ste 123  
Cambridge Ontario Canada  
N1S 5A5*